

Wiring Information

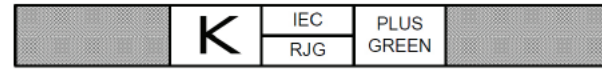

Wiring Guide	
+ (Plus) Signal	Green
- (Negative) Signal	White

Ordering Information

1.5 mm Temperature Sensor Part Numbers	
Sensor with .5m Cable and Nut	TS-SL01.5-K-.5m
Sensor with 1m Cable and Nut	TS-SL01.5-K-1m
Sensor with 2m Cable and Nut	TS-SL01.5-K-2m

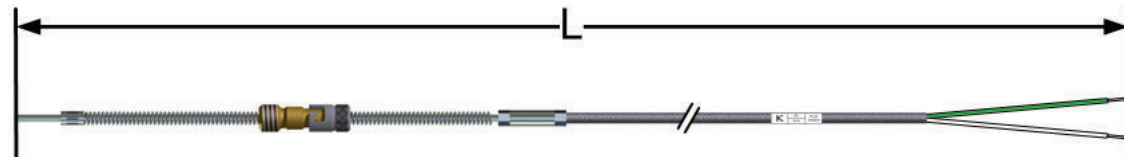

Sensor Depth and Response Time

The graph below shows how the depth of D can effect the response time to the arrival of the melt front. All times refer to time difference relative to a flushmount application of the temperature sensor

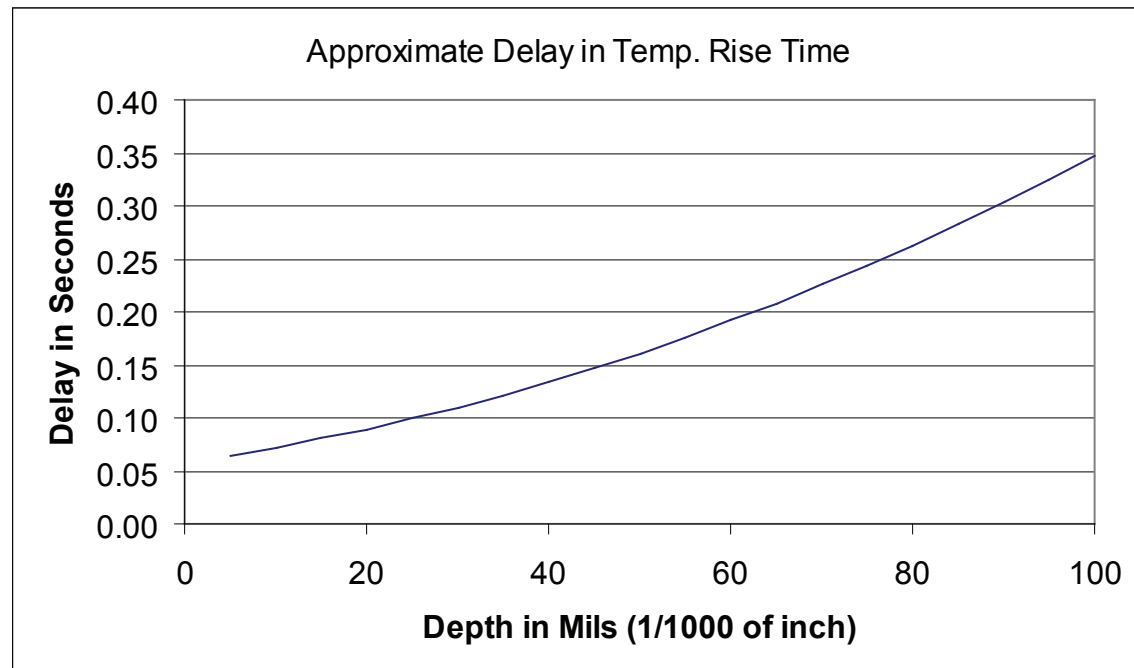

For further Information please contact RJG Customer Support at 231-947-3111 ext. 170 or visit our website at: http://rjginc.com/resource_product.html to obtain detailed manuals

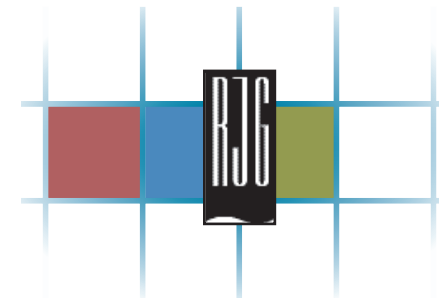

1.5 mm Spring Loaded Temperature Sensor TS-SL01.5-K



GENERAL DESCRIPTION

The 1.5 mm Spring Loaded Temperature Sensor is a miniaturized K type temperature sensor designed for application where a witness mark is to be avoided. The TS-SL01.5-K. can be mounted up behind the cavity surface.



Technical Specifications	
Sensor tip diameter	1.5 mm [0.0591"]
Thermocouple Type	Type K Grounded
Temperature Range	+850°C [+1562°F]
Sensor	+ 850 °C [+ 1562 °F]
Transitional Fitting	+ 250 °C [+ 482 °F]
Cable	+ 350 °C [+ 662 °F]
Accuracy	±1%
Sensor material	Stainless Steel
Connection	Open leads

Table 1: Technical Specifications

HARDWARE INSTALLATION

The 1.5 mm Spring Loaded Temperature Sensor is retained in the mold by a spring loaded bayonet and a brass adapter. Its design allows for easy maintenance and mounting behind the mold surface.

1.5 mm Temperature Sensor TS-SL01.5-K
Spring Loaded

Installation and Application

The sensor tip location and depth (D) are critical if the goal is to monitor plastic flow front arrival timing and/or relative plastic melt temperature. See the table below for applications versus values of D. It is important to get as close as possible to the surface of the mold. For a graph showing how the depth of D can effect the response time to the arrival of the melt front refer to page 4. For more application guidance and information call RJG at (231) 947-3111.

Tip to Mold Depth Table	
Application	Depth to Mold Face
Detect Fill Times and Effective Melt Temperature	D < .38 mm (.015")
Monitor Mold Temperature	.38 mm (.015") < D

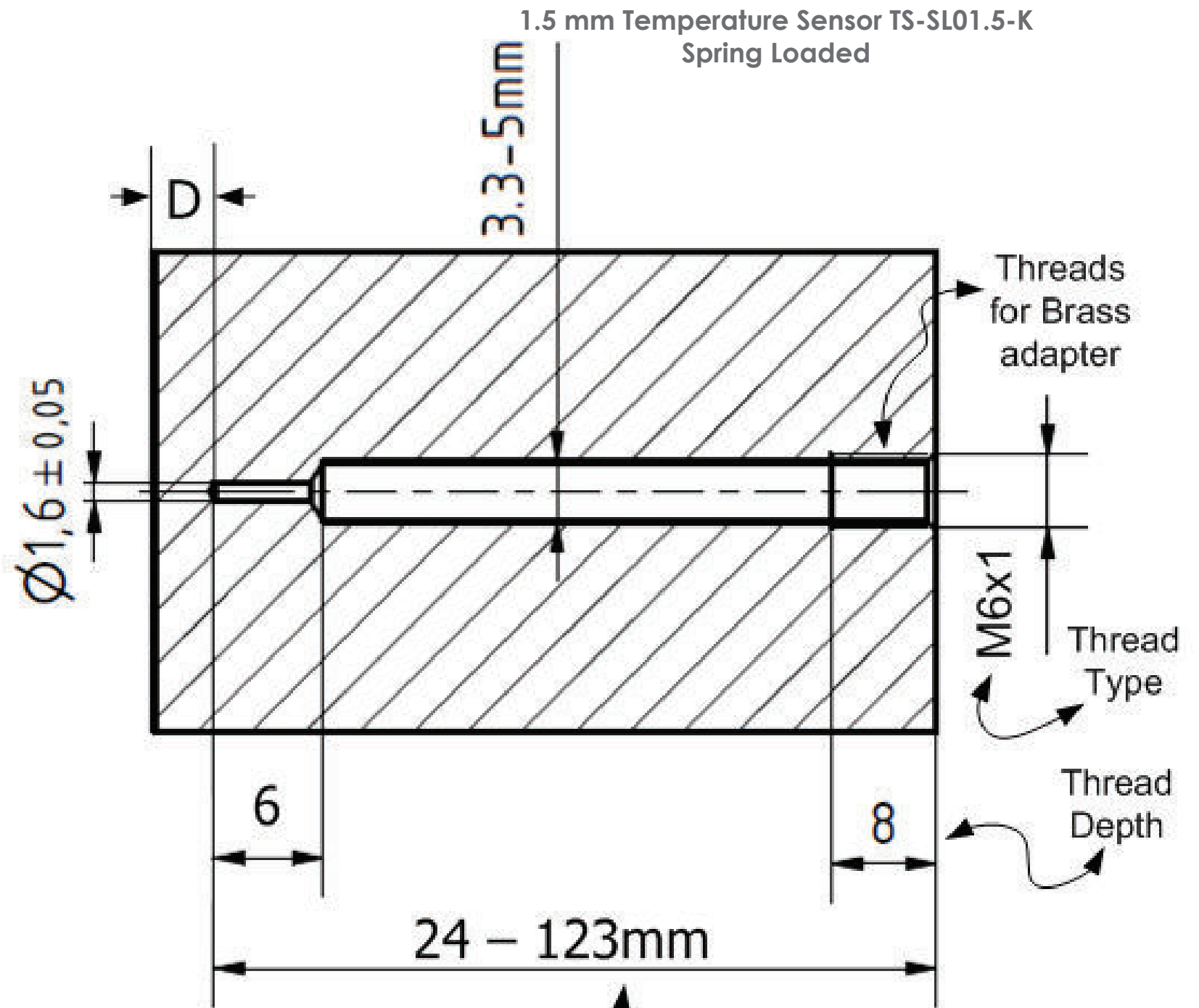

After forming pocket and adapter threads, install brass adapter and adjust sensor tension as outlined below.

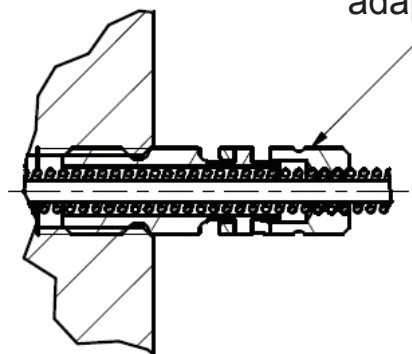

The depth from the tip of the sensor to the plate surface can be between 24 and 123 mm. Adjust the sensor tension by turning the bayonet. The tension should be as tight as possible without inhibiting insertion into the brass adapter.

